



**ATTENTION**

If any components of this unit are broken,  
do not operate properly, or for product returns,  
please contact PragoTrade Inc. at

**1-800-814-4895**

*Outside the U.S. call 440-638-3131.*

For the online catalog, log onto [www.westonsupply.com](http://www.westonsupply.com).

*Exclusively imported by PragoTrade Inc. Strongsville, Ohio*  
[www.pragoTrade.com](http://www.pragoTrade.com)



**Manual Cuber/Tenderizer  
and Manual Jerky Slicer**

# Motor Attachment

**MODEL #01-0103-W**



**KEEP FINGERS CLEAR  
of the cutting blades  
at all times!**



**LISTED**  
E256818  
32PH

*Manual Cuber/Tenderizer  
or Manual Jerky Slicer  
Sold Separately*

*Product color may vary from picture shown.*

REV 05/03/07



**MANUAL CUBER/JERKY SLICER  
MOTOR ATTACHMENT  
INSTRUCTIONS  
MODEL #01-0103-W**

Thank you for purchasing a Weston Brand Manual Cuber/Jerky Slicer Motor, we are sure that you will be pleased with your purchase.

Proper cleaning and maintenance will help ensure that your appliance will continue to perform at its best. Clean and Dry all parts thoroughly before storing. Even though your Weston Brand Manual Cuber/Jerky Slicer Motor is primarily Stainless Steel, you should spray the metal parts with lubricant prior to storage to prevent oxidation.

**WARRANTY INFORMATION**  
SAVE THIS WARRANTY INFORMATION FOR YOUR RECORDS!

Pragotrade Inc. warrants to the ORIGINAL RETAIL PURCHASER of this product that if operated in accordance with the printed instruction accompanying it, then for a period of 1 year from the date of purchase, the product shall be free from defects in material and workmanship.

The Warranty Card, along with a copy of the original receipt, must be received by Pragotrade Inc. within 30 days from purchase date for the warranty to apply. Failure to send the completely filled out Warranty Card, along with a copy of the original receipt, will void the warranty.

The product must be delivered to or shipped freight prepaid to Pragotrade Inc. for warranty services, in either its original packaging or similar packaging affording an equal degree of protection. Damage due to shipping is not the responsibility of the company. Pragotrade Inc. charges a \$35.00 per hour bench charge. NOTE: No repairs will be started without the authorization of the customer. The return shipping cost to the customer will be added to the repair invoice.

Pragotrade Inc. will repair (or at its discretion, replace) the product free of charge, if in the judgment of the company, it has been proven to be defective as to seller's labor and material, within the warranty period.

New or rebuilt replacements for factory defective parts will be supplied for one (1) year from the date of purchase. Replacement parts are warranted for the remainder of the original warranty period.

For non-warranty repairs, contact Pragotrade's Customer Service at 1-800-814-4895 M-F 8am-5pm EST (outside of the United States 440-638-3131) to obtain a Return Authorization Number (RMA Number). Pragotrade will refuse all returns that do not contain this number. **DO NOT RETURN THE UNIT WITHOUT PROPER AUTHORIZATION FROM PRAGOTRADE USA, INC.**

**LIMITATIONS:** The warranty is void if the product is used for any purpose other than which it is designed. The product must not have been previously altered, repaired, or serviced by anyone else other than Pragotrade Inc. If applicable, the serial number must not have been altered or removed. The product must not have been subjected to accident in transit or while in the customer's possession, misused, abused, or operated contrary to the instructions contained in the instruction manual. This includes failure caused by neglect of reasonable and necessary maintenance, improper line voltage and acts of nature. This warranty is not transferable and applies only to U.S. and Canadian sales.

Except to the extent prohibited by applicable law, no other warranties whether expressed or implied, including warranty merchantability and fitness for a particular purpose, shall apply to this product. Under no circumstances shall Pragotrade Inc. be liable for consequential damages sustained in connection with said product and Pragotrade Inc. neither assumes nor authorizes any representative or other person to assume for it any obligation or liability other than such as is expressly set forth herein. Any applicable implied warranties are also limited to the one (1) year period of the limited warranty.

This warranty covers only the product and its specific parts, not the food or other products processed in it. **CUT ALONG THE DOTTED LINE AND SEND THE WARRANTY CARD ALONG WITH A COPY OF YOUR ORIGINAL PURCHASE RECEIPT TO:**

**Pragotrade Inc.  
20365 Progress Drive, Strongsville, OH 44149**

**WARRANTY CARD**  
SEND THIS CARD ALONG WITH A COPY OF YOUR ORIGINAL PURCHASE RECEIPT

Customer Name: \_\_\_\_\_

Address: \_\_\_\_\_

City/State/Zip: \_\_\_\_\_

Telephone Number: (\_\_\_\_\_) \_\_\_\_\_

E-Mail Address: \_\_\_\_\_

Original Date of Purchase: \_\_\_\_/\_\_\_\_/\_\_\_\_

Product Model #: \_\_\_\_\_

Serial # (if applicable): \_\_\_\_\_

9. Install the Bracket Arm onto the two 110mm Hex Head Bolts. Screw the two Wing Nuts onto the bolts and tighten until the Motor is secured in place. *Figure 7*  
 Note: DO NOT over tighten the Wing Nuts, tighten only enough to secure the motor in place. If the Wing Nuts are too tight, the Motor may bind during use.

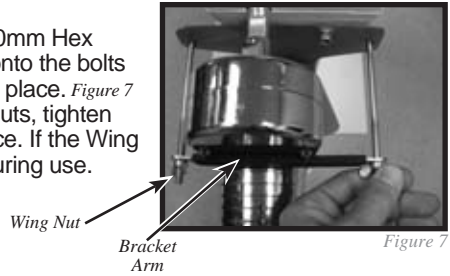

10. The unit is now fully assembled and ready for use. Be sure to read and understand the instructions that came with your cuber/jerky slicer for safe operation.



Fully assembled Motor

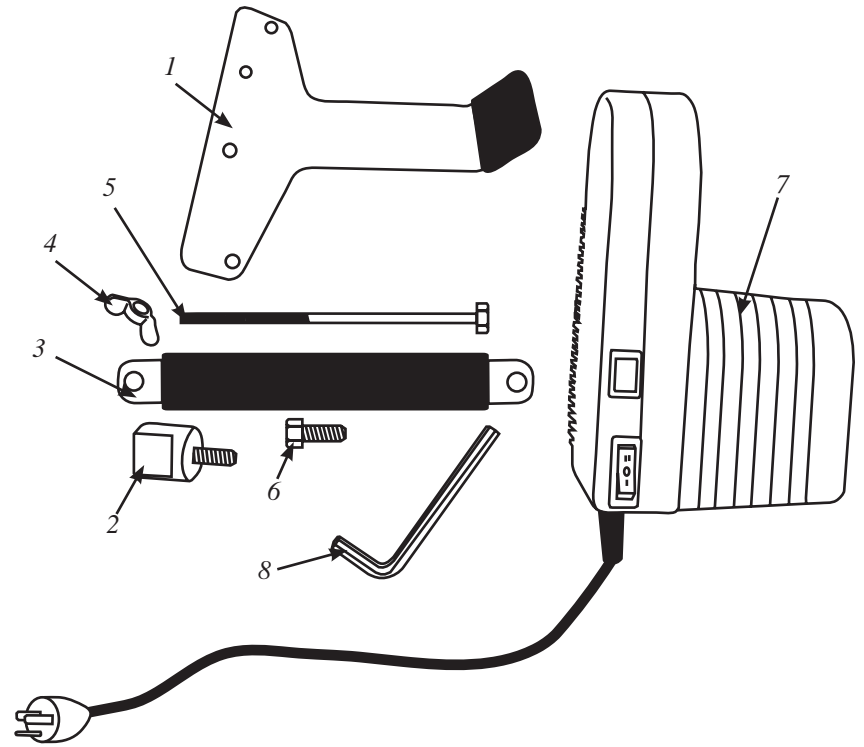

## COMPONENT LIST

DIAGRAM NUMBER	PART DESCRIPTION	PART #
1	Motor Bracket	01-0104
2	Adapter	01-0105
3	Bracket Arm	01-0106
4	MG Wing Nut (2)	01-0107
5	110mm Hex Head Bolt (2)	01-0108
6	16mm Allen Head Bolt (2)	01-0109
7	Motor	01-0101
8	Allen Wrench	01-0111

If any components of this unit are broken or the unit does not operate properly, call Pragotrade Inc. Toll Free at

**1-800-814-4895**

Monday thru Friday 8:00am-5:00pm EST.  
 Outside the U.S. call 440-638-3131

## GENERAL SAFETY RULES

### WARNING!

**READ AND FULLY UNDERSTAND ALL INSTRUCTIONS AND WARNINGS PRIOR TO USING THIS PRODUCT. YOUR SAFETY IS MOST IMPORTANT: FAILURE TO COMPLY WITH PROCEDURES AND SAFE GUARDS MAY RESULT IN SERIOUS INJURY OR PROPERTY DAMAGE. REMEMBER: YOUR PERSONAL SAFETY IS YOUR RESPONSIBILITY!**

1. ALWAYS DISCONNECT product from power source before servicing or cleaning the unit.
2. KEEP FINGERS CLEAR of the cutting blades at all times. Failure to keep fingers clear of the cutting blades may result in personal injury.
3. NEVER REACH INTO the top opening, doing so could cause serious injury. Always use the provided tongs.
4. KEEP CHILDREN AWAY. NEVER LEAVE THE UNIT UNATTENDED. Be safe, DISCONNECT from power source before leaving the work area.
5. REDUCE RISK OF UNINTENTIONAL STARTING. Make sure the power switch is in the "OFF" position before attaching to the power source. In the event of a power failure, move the switch to the "OFF" position.
6. CHECK FOR DAMAGED PARTS. Before using the Motor, check that all parts are operating properly, and perform the intended functions. Check for alignment of moving parts, binding of moving parts, mounting and any other conditions that may affect the operation.
7. DO NOT USE the Motor if the power cord is damaged. It MUST be replaced before using the motor. Do not modify the cord provided. DO NOT allow the power cord to drape into your work area.

8. FOLLOW THE MANUFACTURERS SAFETY INSTRUCTIONS on the cuber/jerky slicer and the Motor.
9. TIE BACK loose hair and clothing, and roll up long sleeves before operating the Motor. REMOVE ties, rings, watches, bracelets, or other jewelry before operating the Motor.
10. WEAR EYE PROTECTION. Wear safety glasses. Everyday eye glasses are not safety glasses. Safety glasses conform to ANSI Z87.1 requirements. Note: approved safety glasses have Z87 printed or stamped on them.
11. Do not use the Motor while under the influence of drugs, alcohol or medications.
12. Do not overreach, keep proper footing and balance at all times.
13. DO NOT FORCE THE UNIT. The cuber/jerky slicer will do the job better and is safer at the rate for which it was designed.
14. STAY ALERT! Watch what you are doing. A moment of inattention while operating the unit may result in serious personal injury.

## SAVE THESE INSTRUCTIONS!

Refer to them often and use them to instruct others.

## ASSEMBLY INSTRUCTIONS

1. Set up the manual cuber/jerky slicer per the instructions that came with the unit.
2. Remove the handle from the manual cuber/jerky slicer and set it aside. The handle will not be used when the motor is attached.
3. Using the provided Allen Wrench, remove the two socket head screws from the handle side of the manual cuber/jerky slicer. *Figure 1*

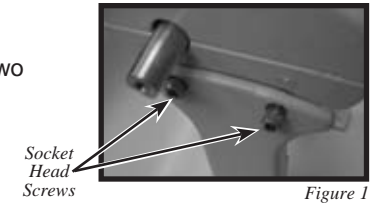

4. Position the Motor Bracket so that the holes in the bracket line up with the holes on the handle side of the cuber/jerky slicer. *Figure 2*

*Figure 2*

5. Install the two provided 16mm Allen Head Bolts through the Motor Bracket and into the cuber/jerky slicer housing. Be sure the bolts are firmly tightened. *Figure 3*

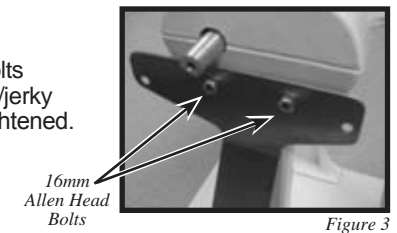

*Figure 3*

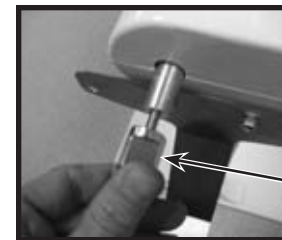

6. Screw the Adapter into the cuber/jerky slicer. *Figure 4*

*Figure 4*

7. Insert the Motor Shaft fully into the Adapter, allowing the Motor to rest on the Motor Bracket. *Figure 5*  
Note: The Motor Shaft may need to be rotated for proper alignment.

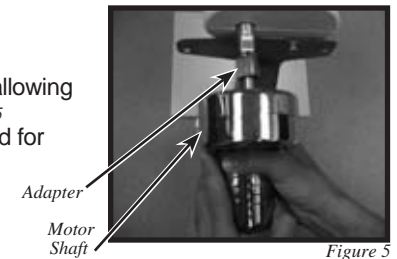

*Figure 5*

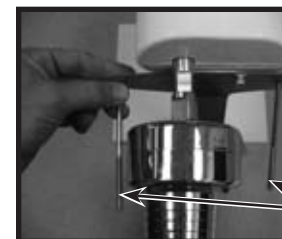

8. Slide the two 110mm Hex Head Bolts through the holes in the Bracket. *Figure 6*  
Note: The threaded ends of the bolts should be facing the Motor.

*Figure 6*

